

Diamond Princess

DECK 16 - SPORTS

PRINT DECK

EXIT FULL SCREEN

HELP

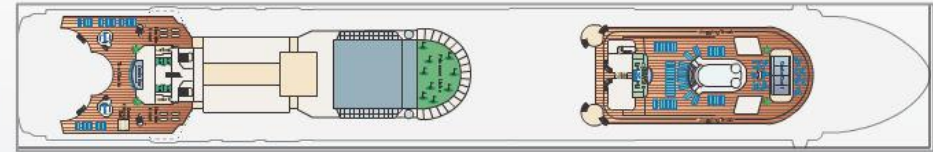

RESET

*DECK PLANS VALID AS OF JANUARY 1, 2009. SUBJECT TO CHANGE AT ANY TIME.

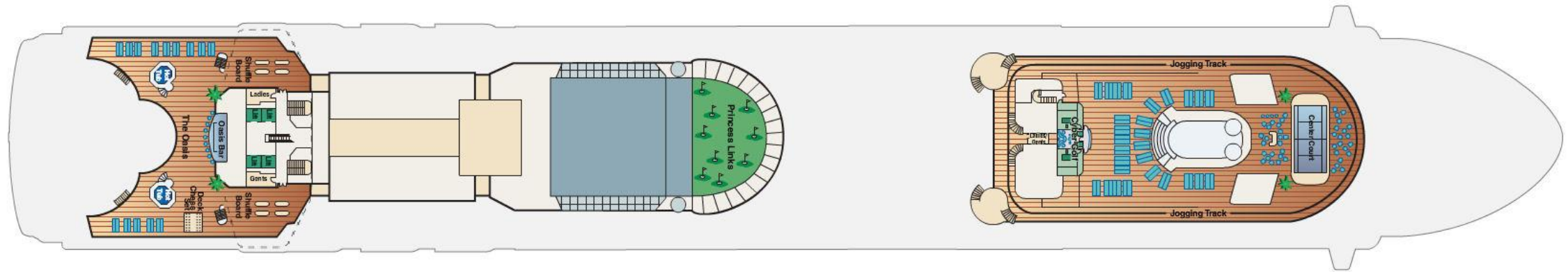

Diamond Princess

DECK 15 - SUN

PRINT DECK

EXIT FULL SCREEN

HELP

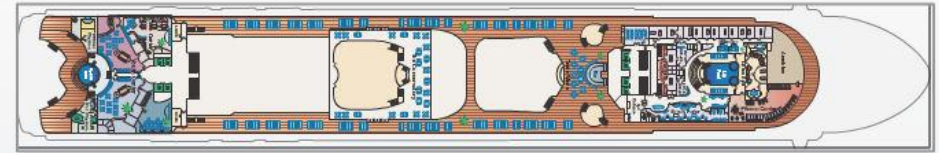

*DECK PLANS VALID AS OF JANUARY 1, 2009. SUBJECT TO CHANGE AT ANY TIME.

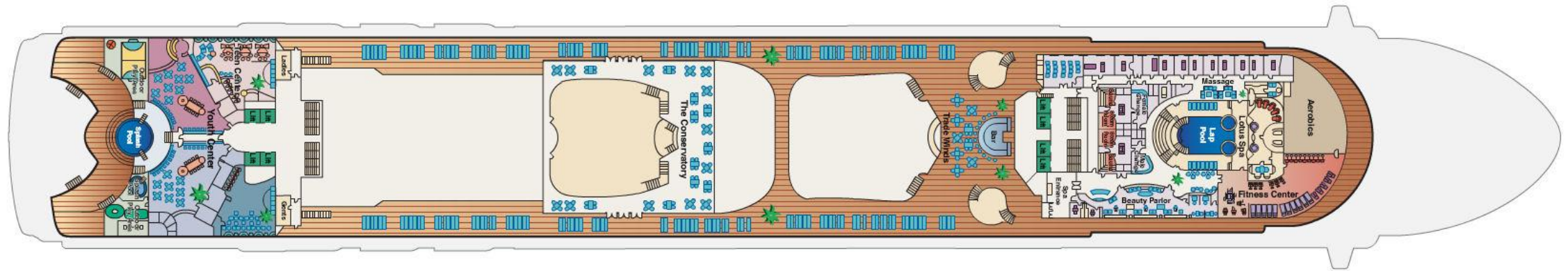

Diamond Princess

DECK 14 - LIDO

PRINT DECK

EXIT FULL SCREEN

HELP

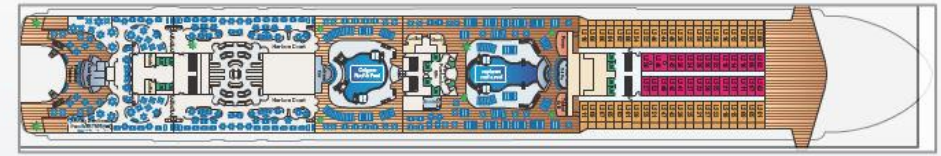

Navigation controls: a slider bar, a minus sign (-), a plus sign (+), and a RESET button with a circular arrow icon.

*DECK PLANS VALID AS OF JANUARY 1, 2009. SUBJECT TO CHANGE AT ANY TIME.

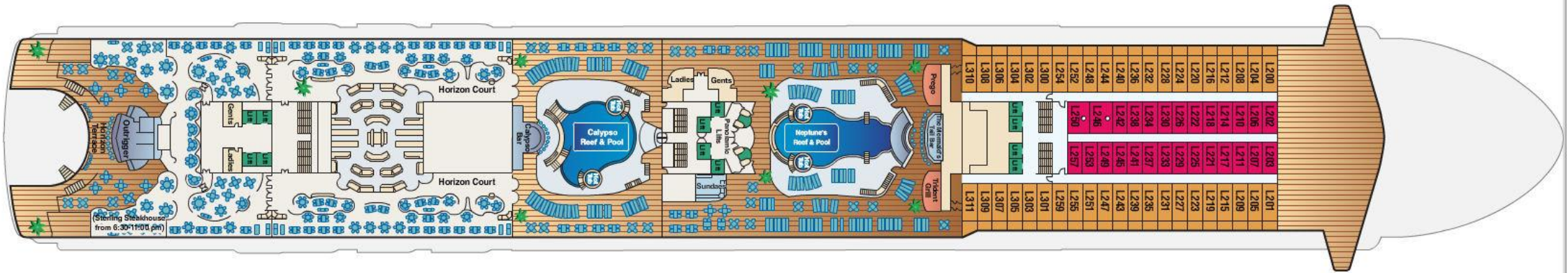

Diamond Princess

DECK 12 - ALOHA

PRINT DECK

EXIT FULL SCREEN

HELP

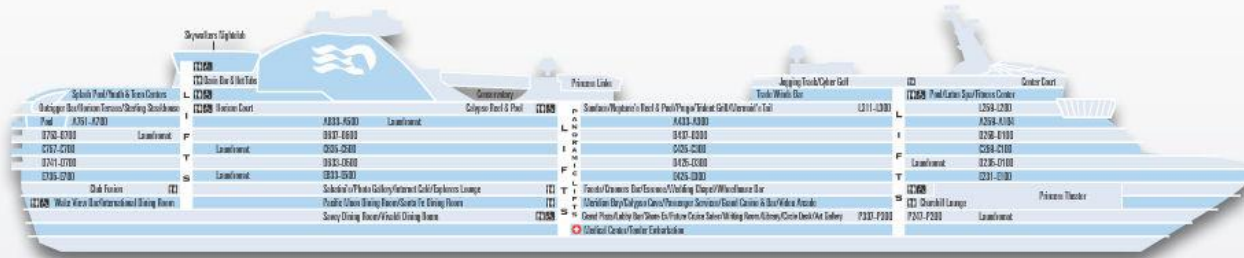

*DECK PLANS VALID AS OF JANUARY 1, 2009. SUBJECT TO CHANGE AT ANY TIME.

RESET

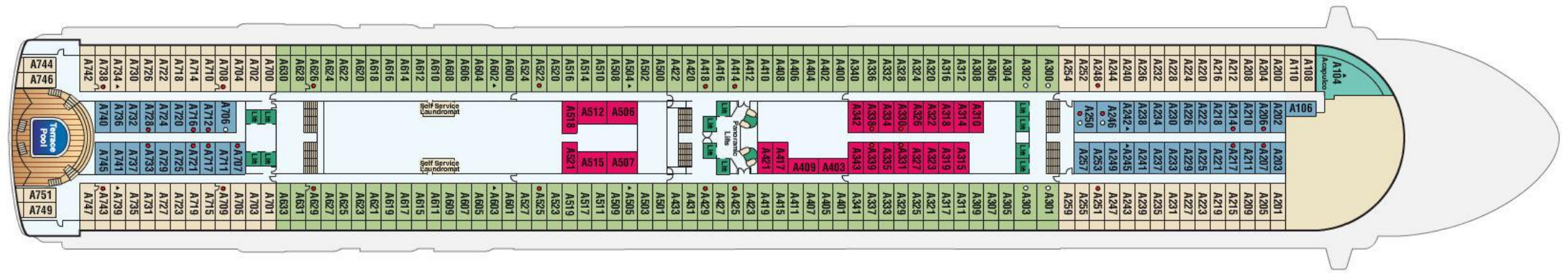

Diamond Princess

DECK 11 - BAJA

PRINT DECK

EXIT FULL SCREEN

HELP

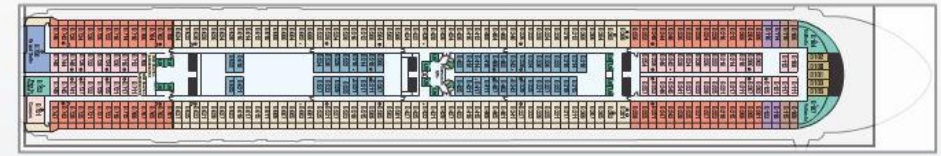

*DECK PLANS VALID AS OF JANUARY 1, 2009. SUBJECT TO CHANGE AT ANY TIME.

RESET

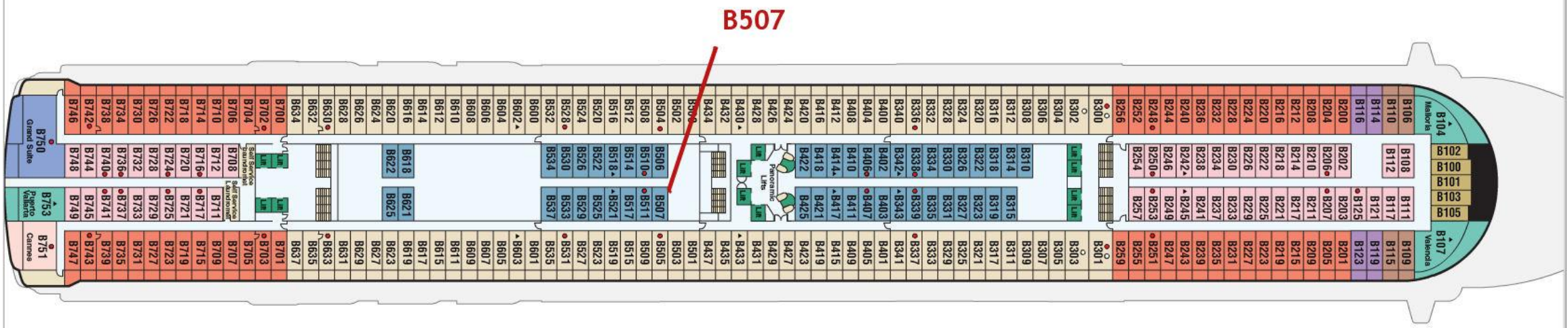

Diamond Princess

DECK 7 - PROMENADE

PRINT DECK

EXIT FULL SCREEN

HELP

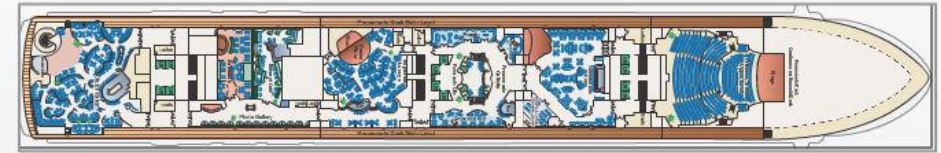

RESET

*DECK PLANS VALID AS OF JANUARY 1, 2009. SUBJECT TO CHANGE AT ANY TIME.

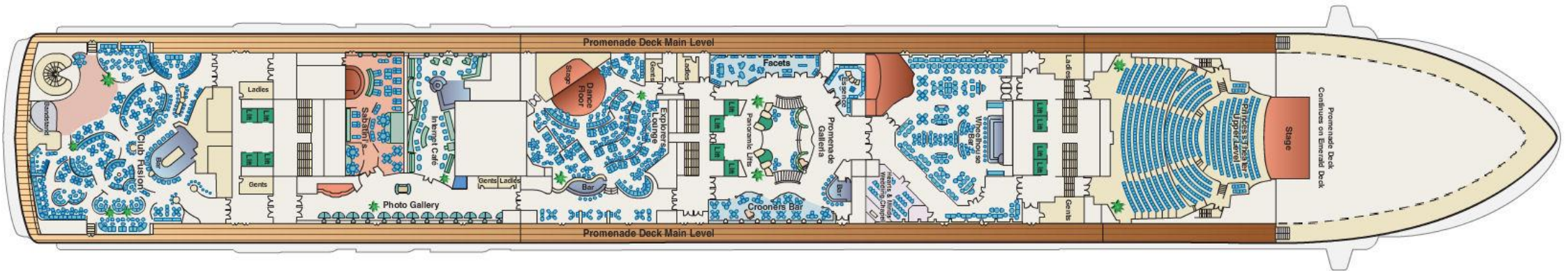

Diamond Princess

DECK 5 - PLAZA

PRINT DECK

EXIT FULL SCREEN

HELP

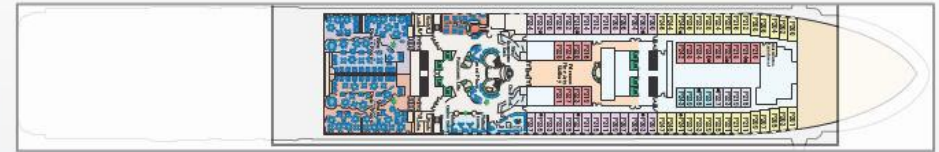

*DECK PLANS VALID AS OF JANUARY 1, 2009. SUBJECT TO CHANGE AT ANY TIME.

RESET

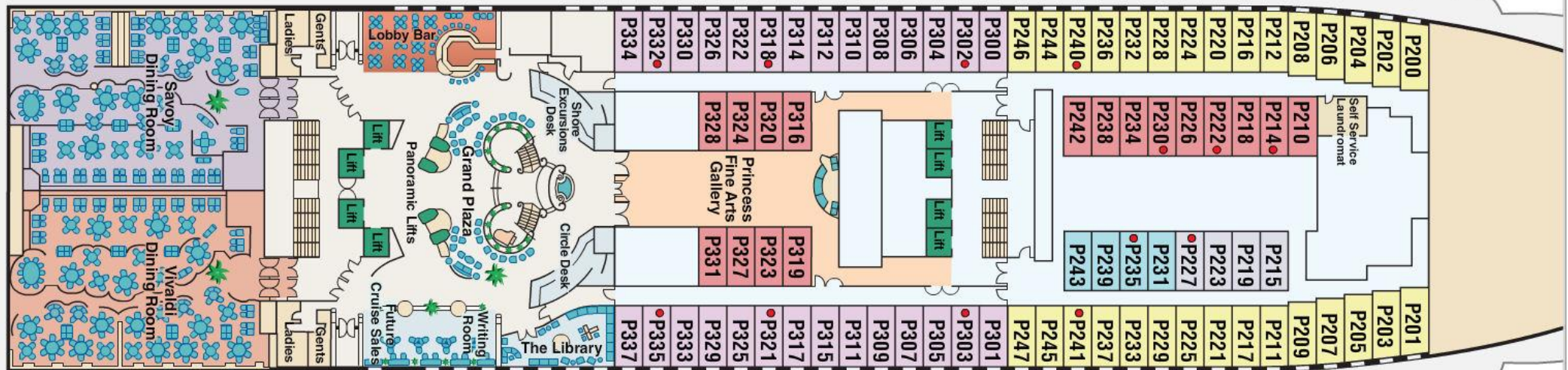

Diamond Princess

DECK 4 - GALA

PRINT DECK

EXIT FULL SCREEN

HELP



Ship layout diagram showing deck plan overlays for Deck 4 - Gala. The ship is oriented horizontally with the bow to the right. Deck plan overlays are shown in various colors and are labeled with room numbers and names.

Room Number	Room Name	Deck
1228	1228 Sun Bar & Terrace	L
1229	1229 Sun Court	L
1230	1230 Sun Court	L
1231	1231 Sun Court	L
1232	1232 Sun Court	L
1233	1233 Sun Court	L
1234	1234 Sun Court	L
1235	1235 Sun Court	L
1236	1236 Sun Court	L
1237	1237 Sun Court	L
1238	1238 Sun Court	L
1239	1239 Sun Court	L
1240	1240 Sun Court	L
1241	1241 Sun Court	L
1242	1242 Sun Court	L
1243	1243 Sun Court	L
1244	1244 Sun Court	L
1245	1245 Sun Court	L
1246	1246 Sun Court	L
1247	1247 Sun Court	L
1248	1248 Sun Court	L
1249	1249 Sun Court	L
1250	1250 Sun Court	L
1251	1251 Sun Court	L
1252	1252 Sun Court	L
1253	1253 Sun Court	L
1254	1254 Sun Court	L
1255	1255 Sun Court	L
1256	1256 Sun Court	L
1257	1257 Sun Court	L
1258	1258 Sun Court	L
1259	1259 Sun Court	L
1260	1260 Sun Court	L
1261	1261 Sun Court	L
1262	1262 Sun Court	L
1263	1263 Sun Court	L
1264	1264 Sun Court	L
1265	1265 Sun Court	L
1266	1266 Sun Court	L
1267	1267 Sun Court	L
1268	1268 Sun Court	L
1269	1269 Sun Court	L
1270	1270 Sun Court	L
1271	1271 Sun Court	L
1272	1272 Sun Court	L
1273	1273 Sun Court	L
1274	1274 Sun Court	L
1275	1275 Sun Court	L
1276	1276 Sun Court	L
1277	1277 Sun Court	L
1278	1278 Sun Court	L
1279	1279 Sun Court	L
1280	1280 Sun Court	L
1281	1281 Sun Court	L
1282	1282 Sun Court	L
1283	1283 Sun Court	L
1284	1284 Sun Court	L
1285	1285 Sun Court	L
1286	1286 Sun Court	L
1287	1287 Sun Court	L
1288	1288 Sun Court	L
1289	1289 Sun Court	L
1290	1290 Sun Court	L
1291	1291 Sun Court	L
1292	1292 Sun Court	L
1293	1293 Sun Court	L
1294	1294 Sun Court	L
1295	1295 Sun Court	L
1296	1296 Sun Court	L
1297	1297 Sun Court	L
1298	1298 Sun Court	L
1299	1299 Sun Court	L
1300	1300 Sun Court	L

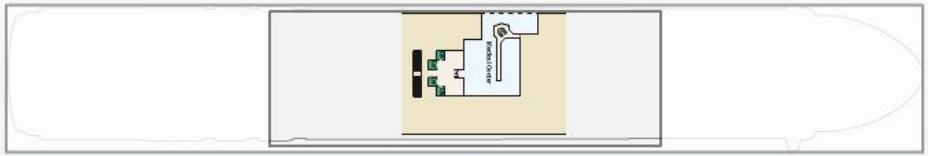

RESET

*DECK PLANS VALID AS OF JANUARY 1, 2009. SUBJECT TO CHANGE AT ANY TIME.

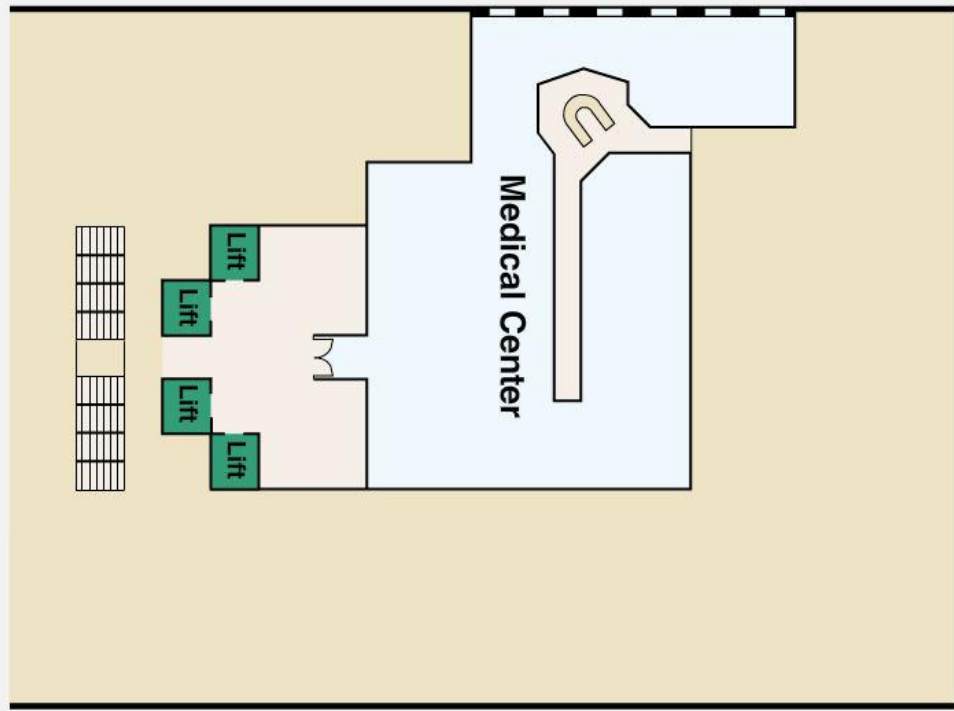

Bow-front

Stern-back

Starboard - right side facing the front

Port - left side facing the front Denoted with a red light at night.

Leeward - In the direction that the wind is blowing towards.

Nautical mile - A distance of 1.852 kilometres (1.151 mi). Approximately the distance of one minute of arc of latitude on the Earth's surface. A speed of one nautical mile per hour is called a *knot* (*qv*).

Sextant - Navigational instrument used to measure a ship's latitude and longitude.

Shift tides - Sighting the positions of the sun and moon using a sextant and using a nautical almanac to determine the location and phase of the moon and calculating the relative effect of the tides on the navigation of the ship,